

THERMALLY BROKEN BI-FOLD DOOR (BOTTOM ROLLING)

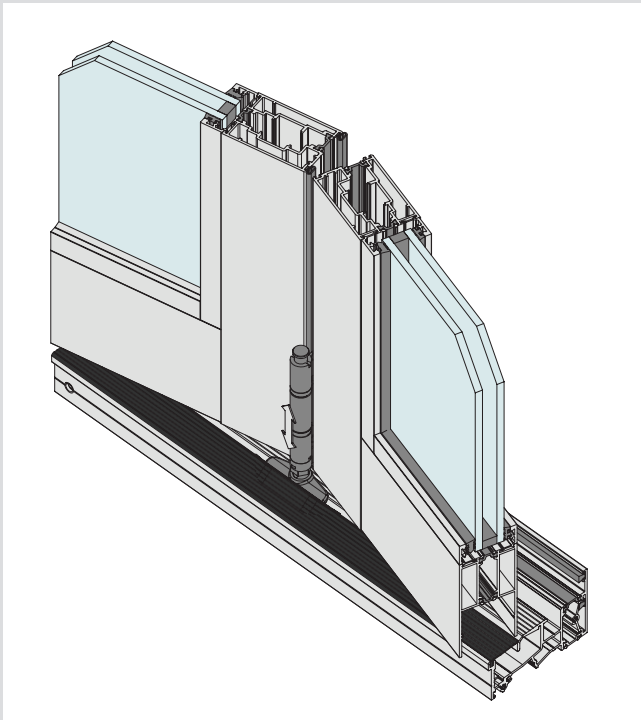

KEY FEATURES

- Bottom rolling commercial bi-fold door system designed to suit ThermalHEART® 100mm x 50mm CentreGLAZE™ and FrontGLAZE™
- Frames can also be fabricated with 17mm Slimline jambs.
- 50mm thick door panels accept thick glass and can achieve very large panel sizes.
- Wide door stiles accept 40mm backset locks that allow easier access to the lock cylinder.
- The standard locks for Series 832 are lever compression locks with ICON™ 316 stainless steel furniture.
- AWS/Centor™ quad stainless steel roller bearings running in heavy duty concealed sill track. The F3 rollers will support panels up to 80Kg.
- Rollers and pivots can be height adjusted as required.
- There is a variety of sill options to choose from. Weather resisting and flush.
- True French meeting stiles for type BFD3+I doors.



Custom extruded flexible cover flap keeps dust and water out of track.



Heavy duty rollers will support panels up to 80kg

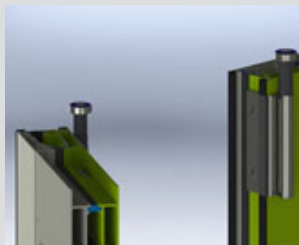

Stainless steel floating head guide running in rigid PVC sleeve to reduce noise.

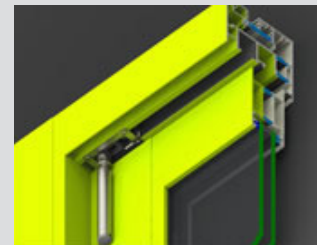

Hinges can be adjusted sideways, up or down.

GENERAL

Max Panel Height
3000mm

Max Panel Width
1000mm

Max Glass Thickness
28mm

Frame Depth
100mm

ENERGY

UW Range
2.4-3.0

SHGC Range
0.21-0.50

WEATHER

Maximum Water
200 Pa.

ACOUSTICS

This product has not been acoustics tested.

